

**L-1 LATCH AND HINGE DETAIL**  
NO SCALE

**L-4 COMPACTOR GATE HOLD-OPEN DETAIL**  
NO SCALE

**L-8 COMBINED CURB & GUTTER**  
SCALE: 1/4" = 1'-0"

**L-11 TYP. ENCLOSURE GATES**  
SCALE: 1/4" = 1'-0"

**L-14 TRAFFIC DIRECTIONAL SIGN**  
SCALE: 3/4" = 1'-0"  
FREESTANDING

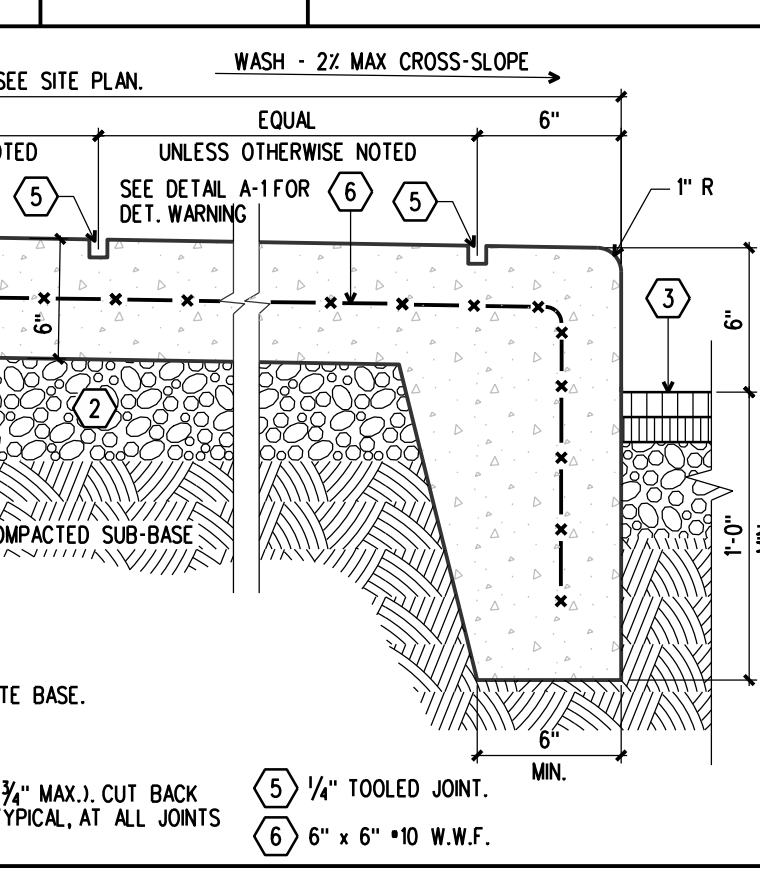
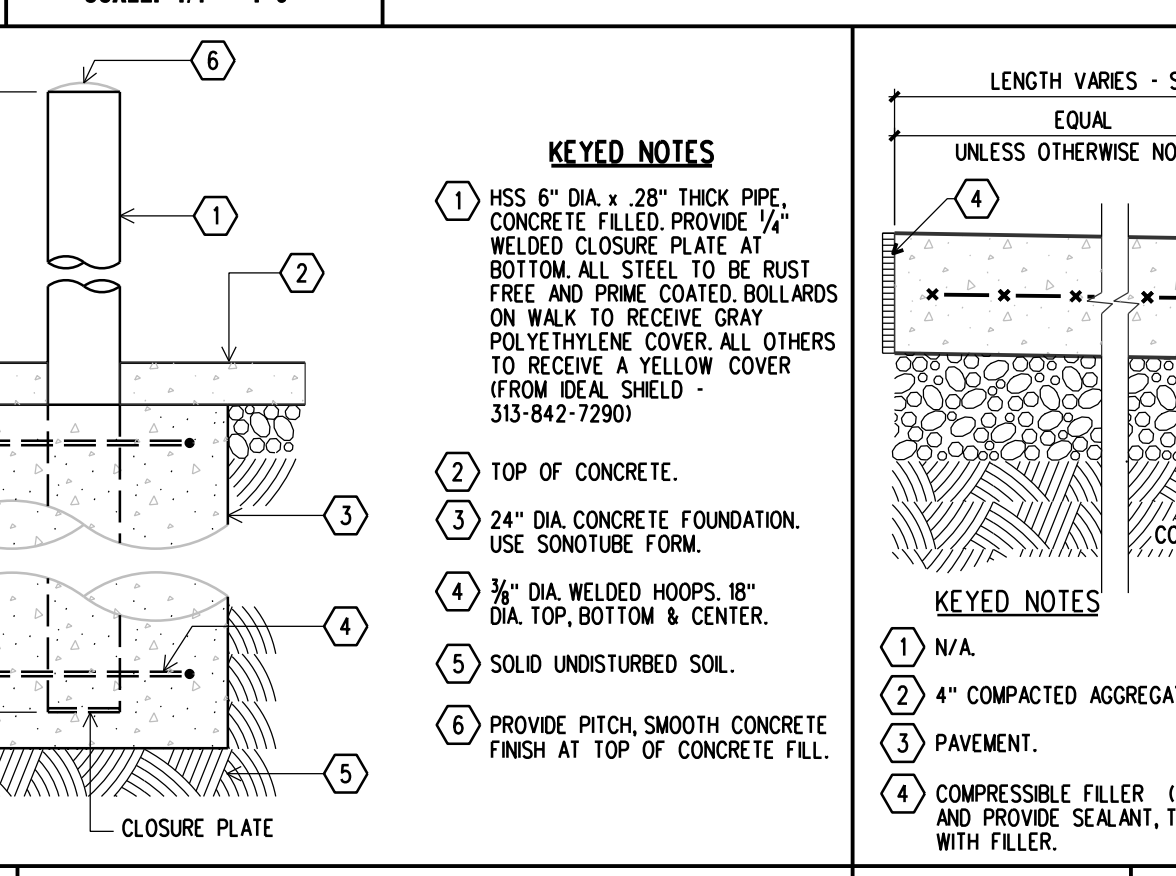
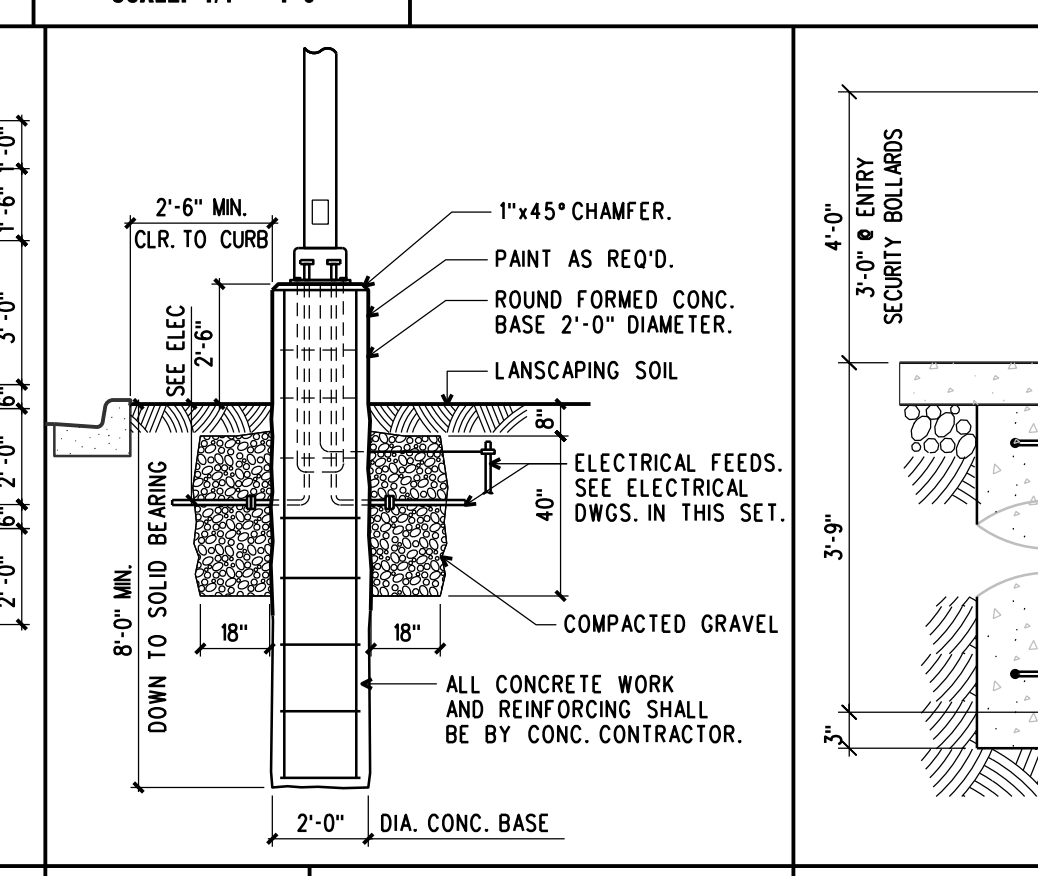
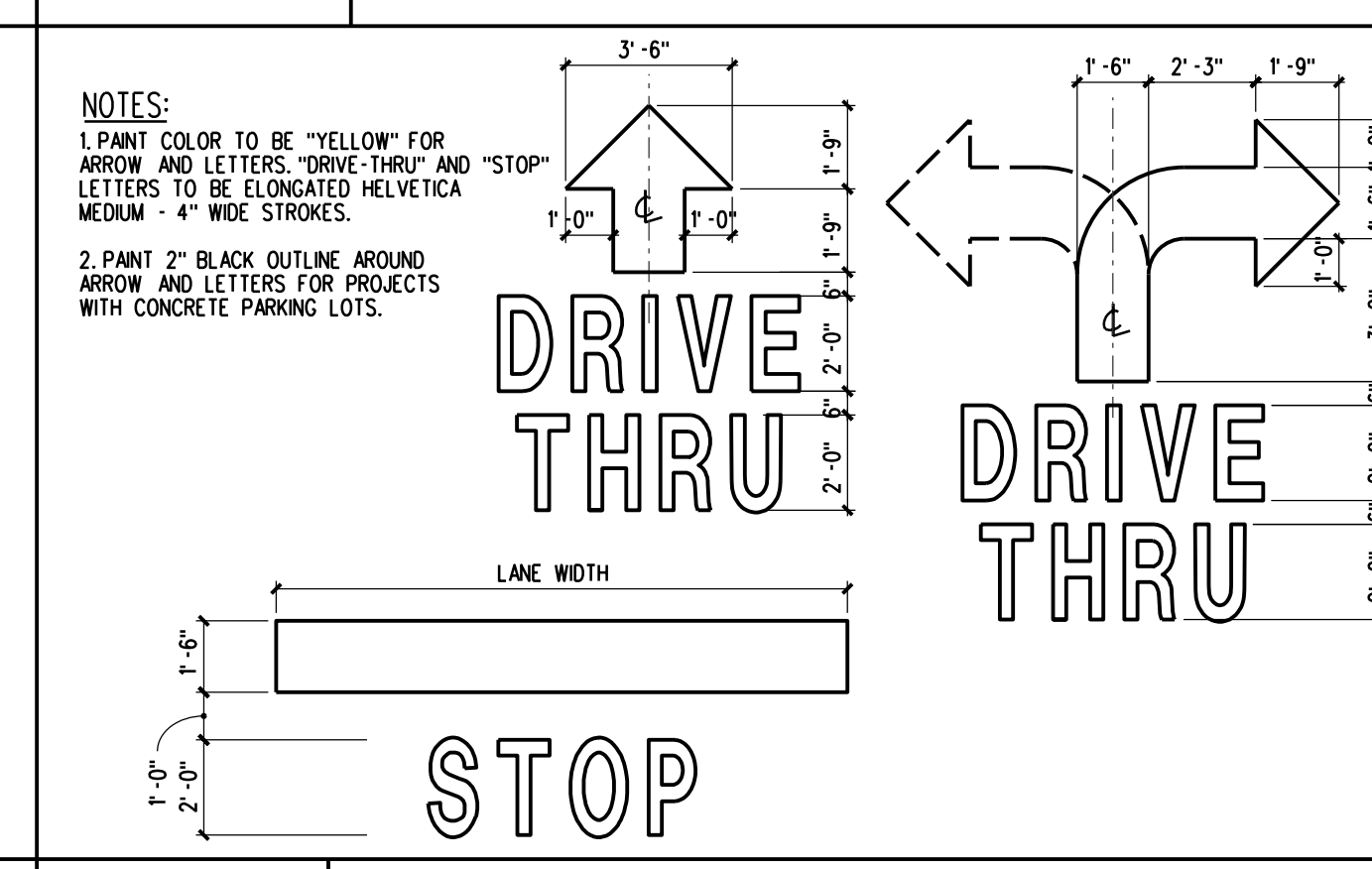
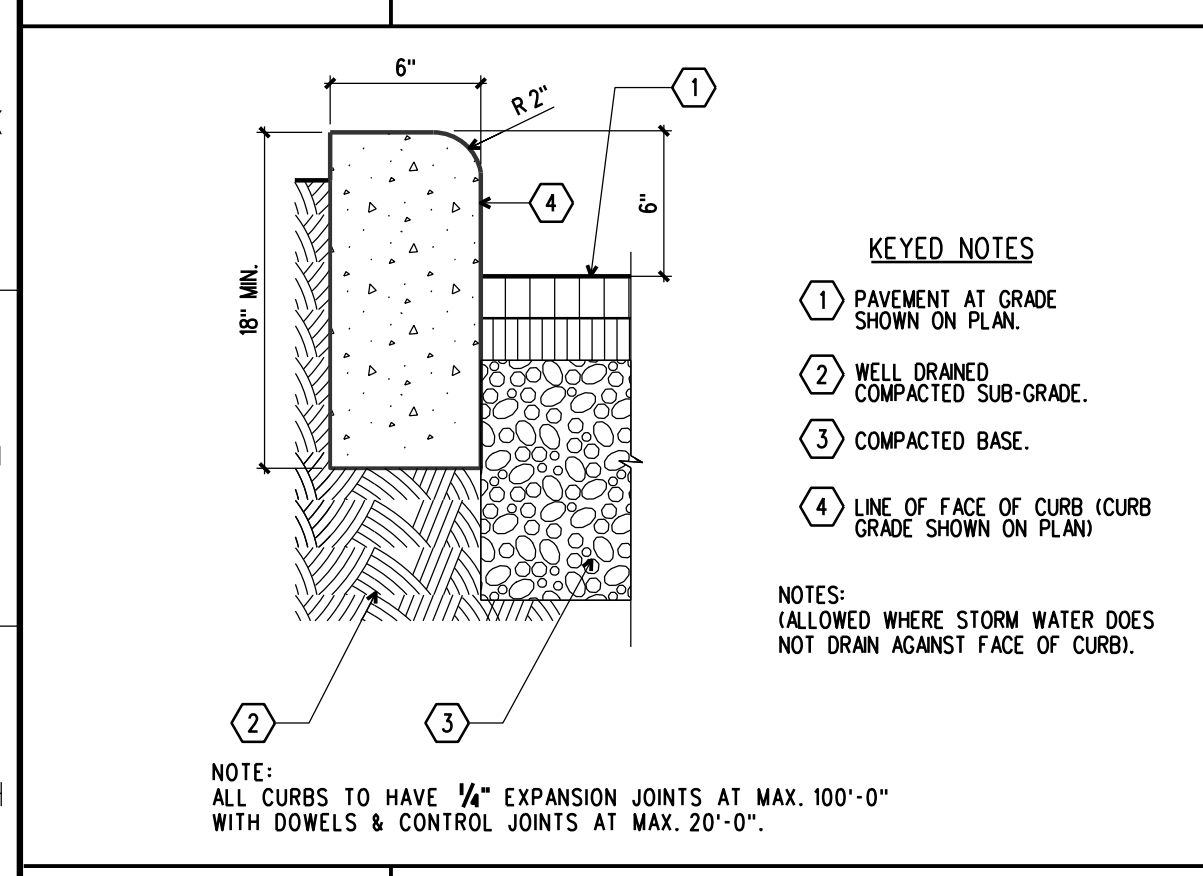

**H-1 VERTICAL CURB DETAIL**  
SCALE: 1/2" = 1'-0"

**H-5 PAVEMENT PAINTING (DIRECTIONAL SIGN)**  
SCALE: 1/4" = 1'-0"  
REFER TO SITE PLAN, SHEET A0.1

**H-8 LIGHT POST DETAIL**  
SCALE: 1/4" = 1'-0"  
SEE SHT. E0.1 FOR LIGHT STANDARD DTLS.

**H-10 TYP. PIPE BUMPER GUARDS**  
SCALE: 1/4" = 1'-0"  
FREE-STANDING

**H-13 TYPICAL PERIMETER SIDEWALK**  
SCALE: 1 1/2" = 1'-0"  
REFER TO SITE PLAN, SHT. A0.1 & CIVIL DRAWINGS

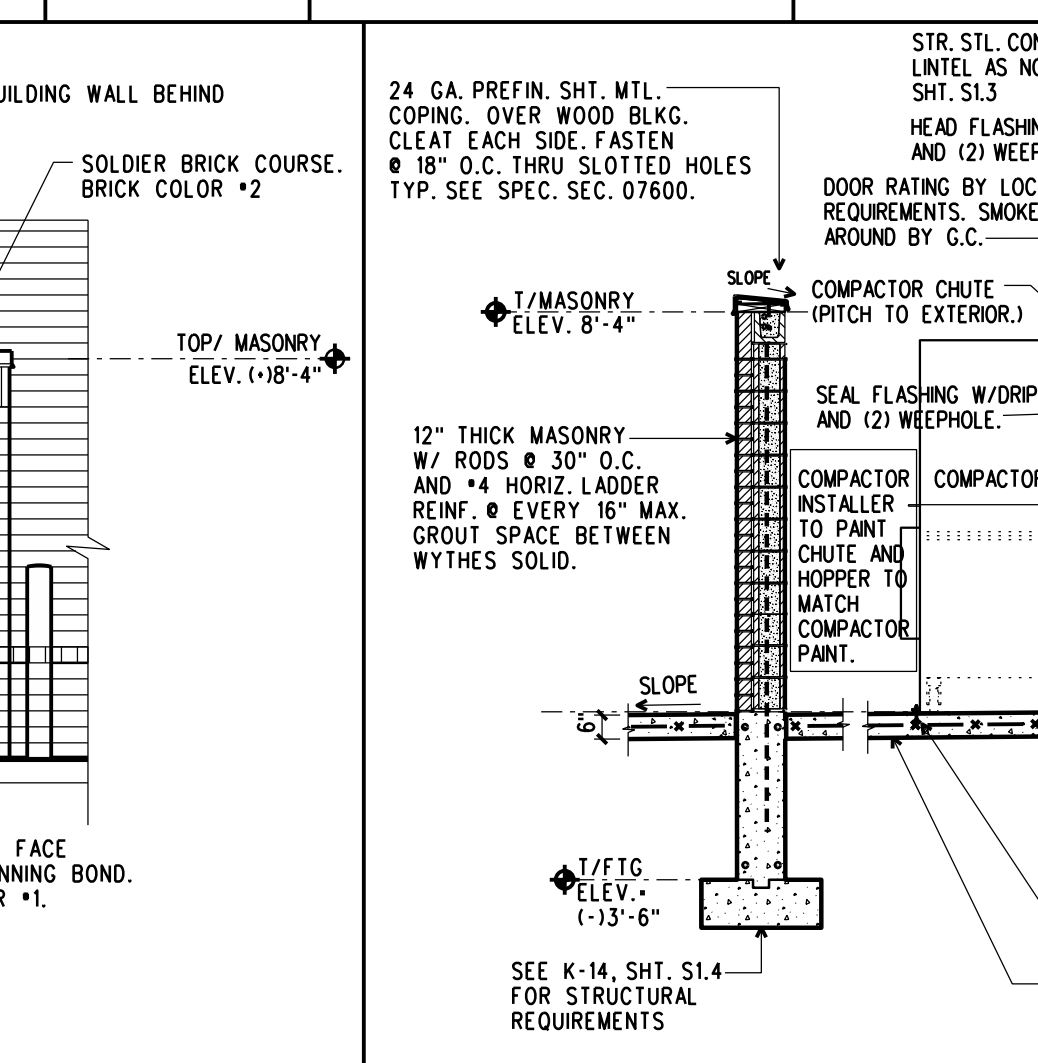
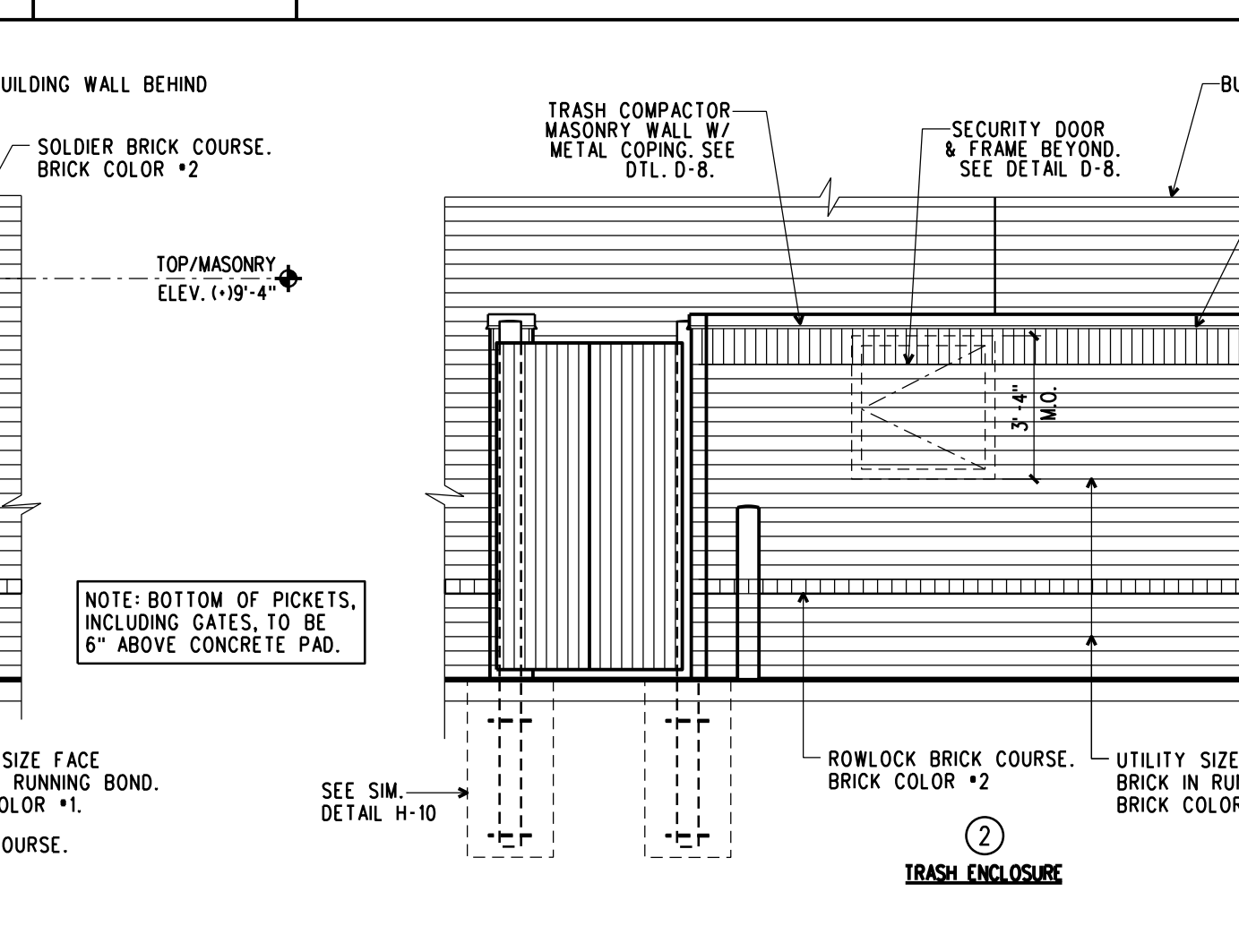
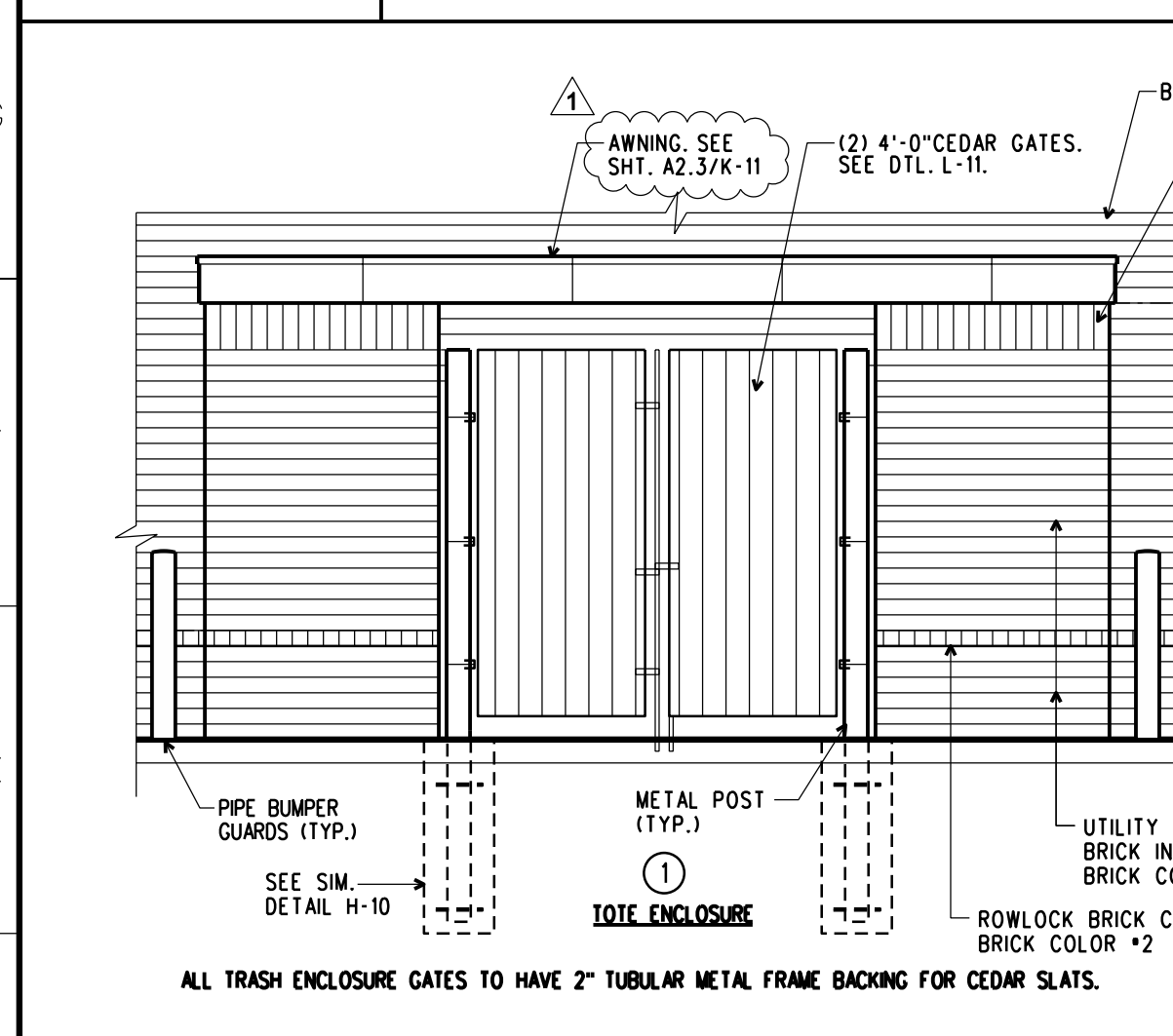

**D-1 TRASH/TOTE ENCLOSURE ELEVATIONS**  
SCALE: 1/4" = 1'-0"  
SEE C0.109 FOR TRASH ENCLOSURE DETAILS

**D-8 SECTION THRU TRASH COMPACTOR**  
SCALE: 1/4" = 1'-0"

**D-13 "NO TRESPASSING" SIGN**  
SCALE: 1 1/2" = 1'-0"

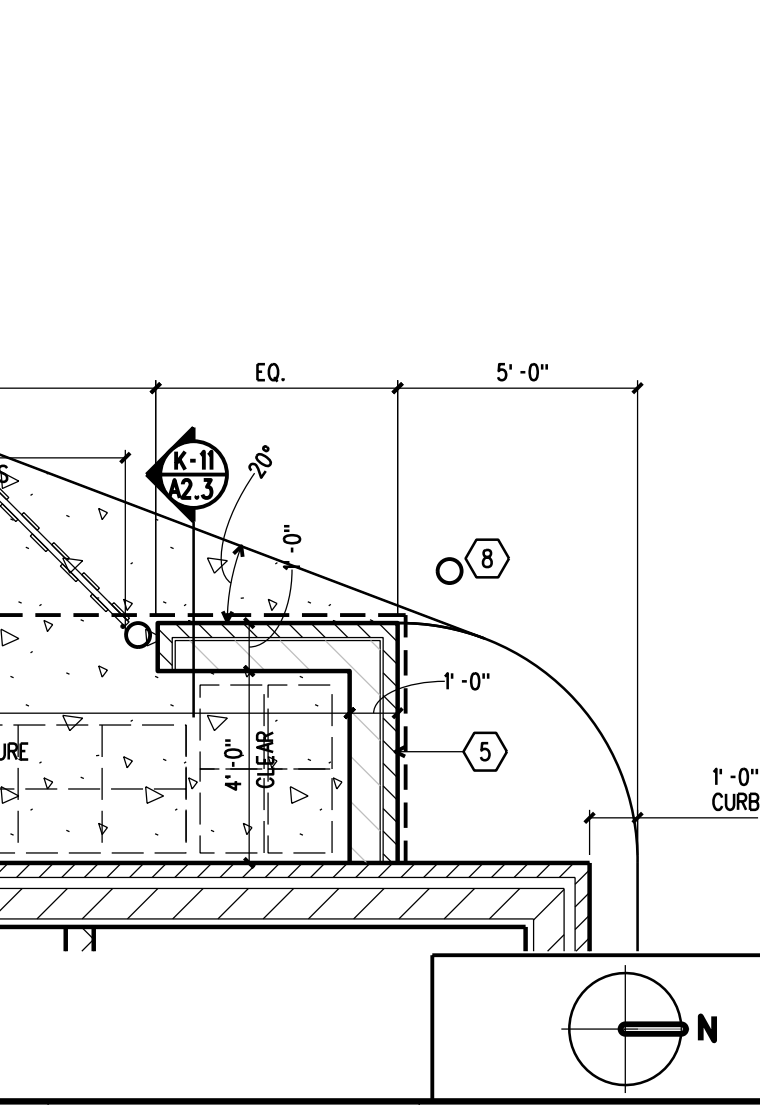
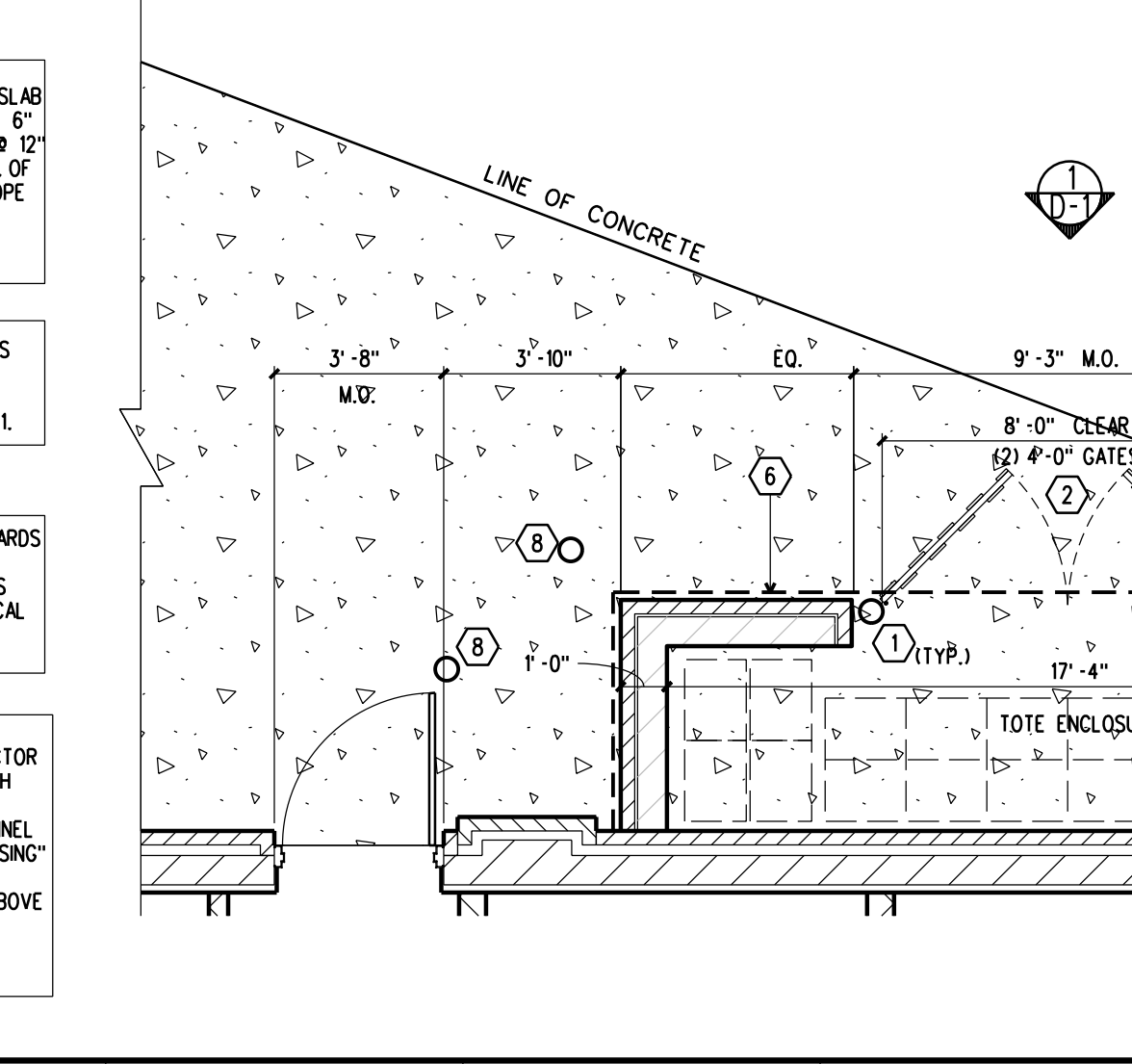
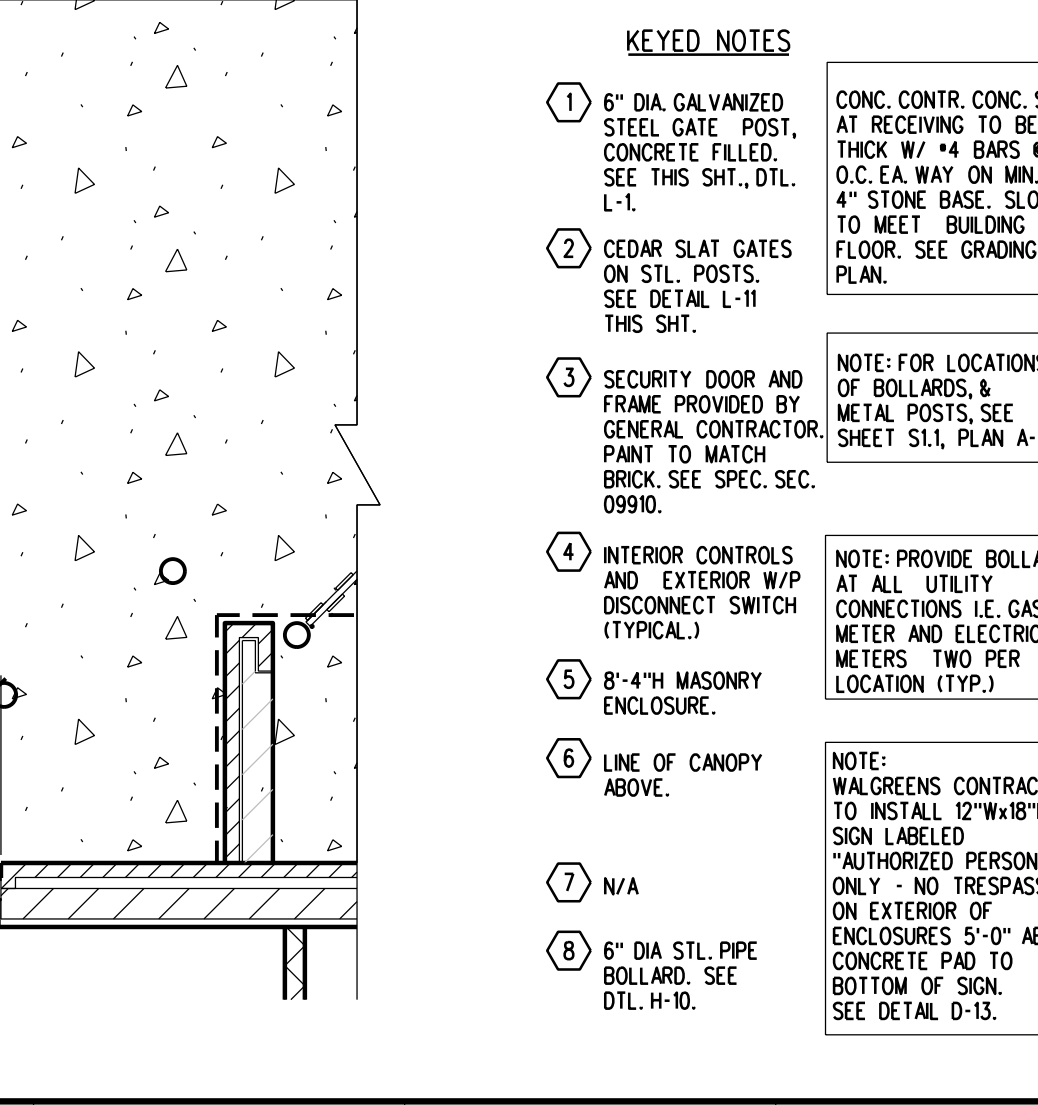
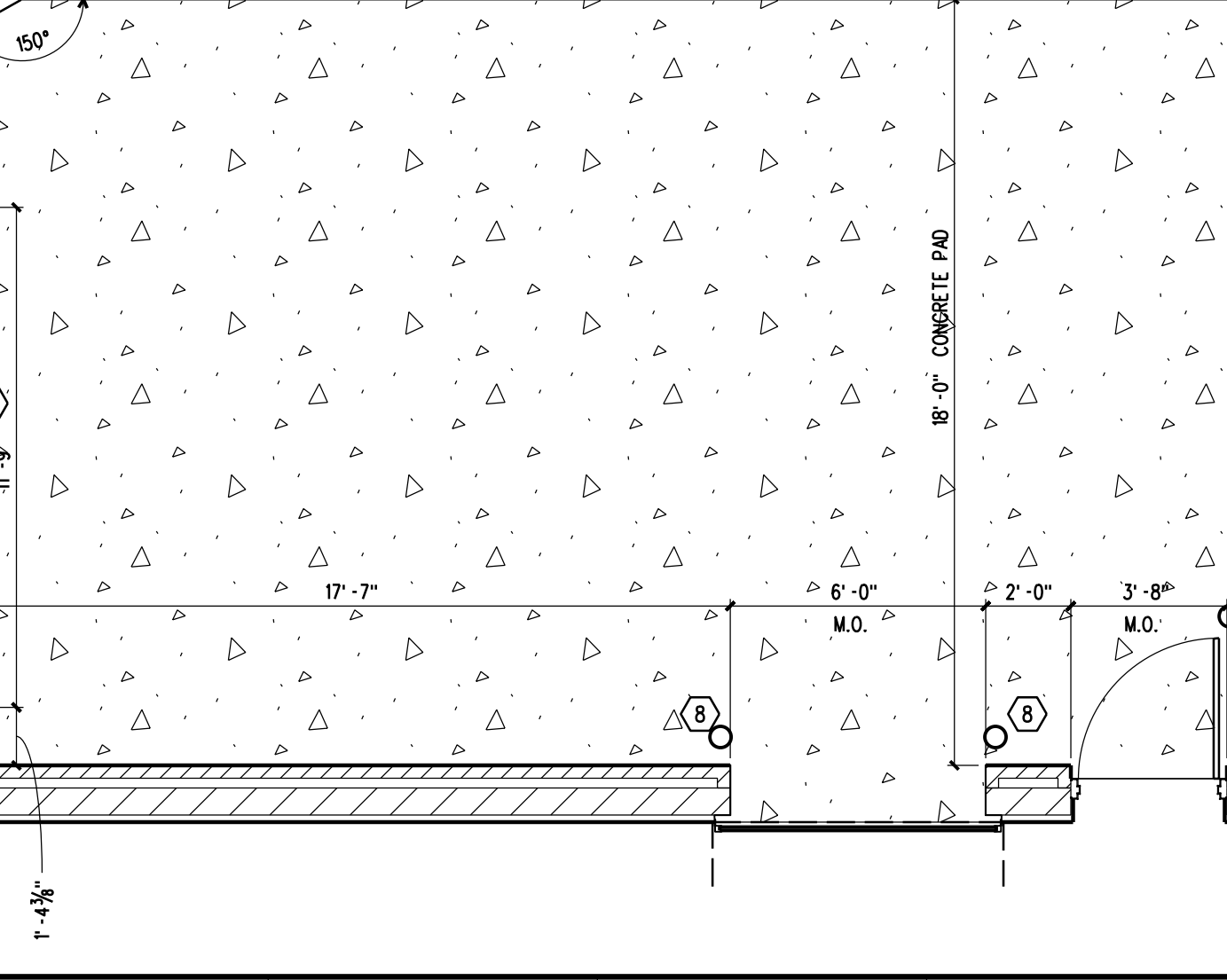
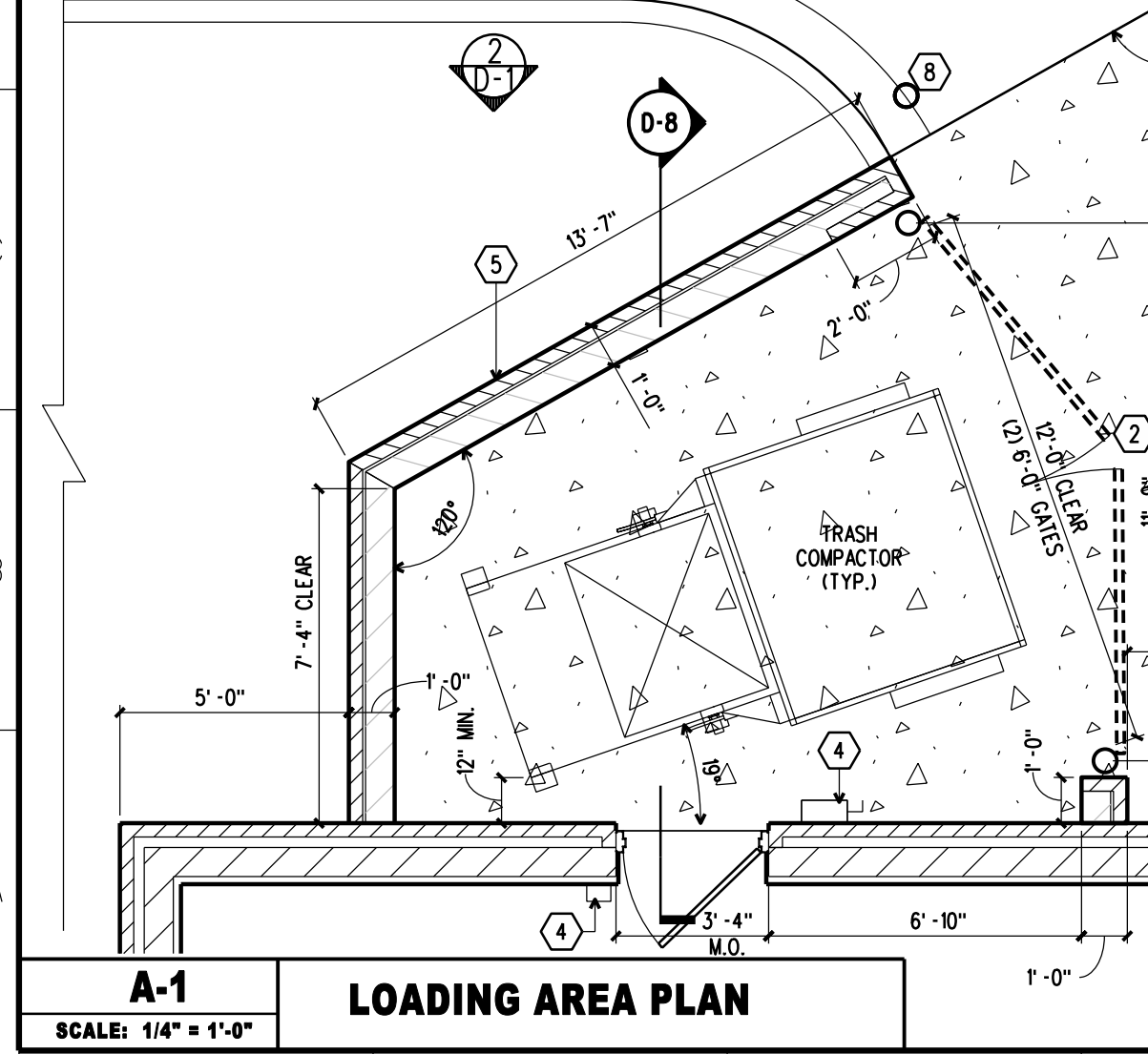

**A-1 LOADING AREA PLAN**  
SCALE: 1/4" = 1'-0"

**D-13 "NO TRESPASSING" SIGN**  
SCALE: 1 1/2" = 1'-0"

**D-13 "NO TRESPASSING" SIGN**  
SCALE: 1 1/2" = 1'-0"

**D-13 "NO TRESPASSING" SIGN**  
SCALE: 1 1/2" = 1'-0"

**D-13 "NO TRESPASSING" SIGN**  
SCALE: 1 1/2" = 1'-0"

**Camburas & Theodore, Ltd.**  
Architecture | Planning | Interiors | Engineering  
2454 E. Dempster St., Des Plaines, IL  
Tel: (847) 298-1525 Fax: (847) 298-0228  
www.camburasandtheodore.com

**PROJECT NO. 91126746**  
**PROJECT TYPE**

**DRAWINGS/SPECIFICATIONS BY:**  
 WALGREENS' CONSULTANT  
 LANDLORD'S CONSULTANT

**ALL CONSTRUCTION WORK, UNLESS NOTED OTHERWISE, BY:**  
 WALGREENS' CONTRACTOR  
 LANDLORD'S CONTRACTOR (TURNKEY CONSTRUCTION)

STORE	BUILDING
NEW <input checked="" type="checkbox"/>	NEW <input checked="" type="checkbox"/>
REMODELING <input type="checkbox"/>	EXISTING <input type="checkbox"/>
RELOCATION <input type="checkbox"/>	NEW SHELL ONLY <input type="checkbox"/>
OTHERS <input type="checkbox"/>	

**GENERAL NOTES**

CONCRETE PAD @ RECEIVING:  
PAD SHALL BE A MIN. OF 3000 P.S.I. AIR ENTRAINED CONC. 6" THICK W/ #4 BARS  
12" O.C. EACH WAY SURFACE TO RECEIVE BROOM FINISH ONE SEAL COAT AND  
SHALL BE FLAT EXCEPT FOR WASH (1.66Z MAX.).

SECURITY DOOR AND FRAME:  
DOOR AND FRAME TO BE PROVIDED AND INSTALLED BY GENERAL CONTRACTOR.  
PROVIDE 3'-4" x 3'-4" MASONRY OPENING WITH SILL 56" A.F.F. AND 52" ABOVE  
GRADE. OUTSIDE DIMENSION (BOTH MINIMUMS MUST BE MET.)

WOOD FENCE ENCLOSURE AND GATES:  
CEGAR WOOD BOARD ON BOARD FENCE W/ CLEAR PROTECTIVE FINISH CEDAR  
WOOD GATES TO BE STEEL FRAMED W/ 6" DIA. STEEL HINGE POSTS AND 2.375" O.D.  
NOM. GALVANIZED LINE POSTS. INDUSTRIAL GRADE CANE DROP BOLTS FOR HOLD-OPEN  
AND SECURE-CLOSE POSITIONS WITH PADLOCK HASP AND GALVANIZED SURFACE-  
MOUNTED BOLT ON HINGES (SIMILAR TO PART #5607) BY MASTER HALCO  
(800.229.5615) OR EQUAL.

NOTE REMOVED

COMPACTOR:  
-ARCHITECT SHALL SEND COMPACTOR INSTALLER ENCLOSURE LAYOUT DRAWINGS  
FOR REVIEW TO COORDINATE CLEARANCES.  
-COMPACTOR IS INSTALLED BY WALGREENS COMPACTOR INSTALLER,  
ASSIGNED TO STATES LISTED BELOW.  
-CONTRACTOR TO COORDINATE WITH WALGREENS EQUIPMENT MANUFACTURER.

IN THE STATES OF AL, AK, AZ, AR, CA, CO, CT, DE, DC, FL, GA, HI, IL, IN, IA, KS,  
KY, LA, ME, MD, MA, MI, MN, MO, MT, NV, NE, NH, NJ, NY, NC, ND, OH, OR, PA, RI, SC,  
TN, TX, UT, VT, WA, WI, WY. CONTACT: ACCOUNT COORDINATOR:  
Sara Cox, J.V. MANUFACTURING, INC., P.O. BOX 229,  
SPRINGDALE, AR 72765, (800)787-7320 x2767.

IN THE STATES OF NJ, NY, AND PA CONTACT ACCOUNT COORDINATOR:  
Colleen Cooper, PTR BALER AND COMPACTOR, 2207 E. ONTARIO ST., PHILADELPHIA,  
PA 19134,  
(800)923-3654 x2211.

**ELECTRICAL POWER:**  
ELECTRICAL CONTRACTOR TO PROVIDE POWER FOR 5 HP, 3 PHASE, 60HZ  
MOTOR 4'-0" A.F.F. AND 30A WEATHER PROOF LOCKABLE DISCONNECT SWITCH  
LOCATED ON EXTERIOR WALL WITHIN 4'-0" OF COMPACTOR. FINAL CONNECTION  
AND CONTROL WIRING BY COMPACTOR INSTALLER.

**NLD HOLDINGS HUDSON, LLC.**  
50 S. 6TH ST. SUITE 1480  
MINNEAPOLIS, MN 55402

**Walgreens**  
Facilities Planning and Design 106 Wilmot Rd., Deerfield, IL 60015  
Tel: (847) 940-2500

NO.	DATE	BY	DESCRIPTION
1	8/23/11	SD	WAG CHECKSET REVISIONS
3	7/28/11	SD	ISSUE FOR CONSTRUCTION
2	7/7/11	SD	OWNER COMMENT REVISIONS
2	8/22/11	SD	ISSUE FOR PERMIT & WAG CHECKSET
1	6/13/11	SD	ISSUE FOR CLIENT REVIEW

**REVISIONS**

**CERTIFICATION AND SEAL**

**STORE NUMBER 15121**  
PROJECT NAME  
WALGREENS  
141 CARMICHAEL ROAD  
HUDSON, WI

**DRAWING TITLE**  
CIVIL ENGINEERING DATA

**CADD PLOT:** SCALE: DRAWING NO.  
**VOID PLOT:** DRAWN BY: SD  
**SUPERSEDES PLAN DATED:** DATE: 4/8/11  
REVIEWED BY: C0.0  
OF DWGS.