

- 1 ACCESSIBLE RAMP W/ DETECTABLE WARNING SURFACE (8.33% MAX SLOPE) COMPLIANT WITH WISCONSIN ADA.
- 2 ELECTRICAL METER. SEE SHTS. A2.1, E0.1 & E1.2.
- 3 PIPE BUMPER GUARD. SEE SHT. CO.0, DETAIL H-10.
- 4 FLEXIBLE DELINEATOR POST AT DRIVE-THRU WINDOW. SEE SHT. A4.4, DETAIL I.
- 5 6" CONCRETE CURB/12" GUTTER. SEE SHT. CO.0, DETAIL L-8.
- 6 1'-0" W X 6" H CONC. CURB.
- 7 NEW CONC. SIDEWALK BY WAG CONTRACTOR. SEE DETAIL H-13, SHT. CO.0 FOR SIDEWALK AT THE BUILDING, OTHERWISE SEE CIVIL.
- 8 25' L X 4" W 4" YELLOW PAINT STRIP LANE DIVIDER.
- 9 PAVEMENT PAINTING: "UNIVERSAL SYMBOL". BLUE PAINTED BORDER W/ WHITE PAINTED WHEELCHAR. SEE SHT. CO.1, DTL. D-1.
- 10 YELLOW PAINT STRIPING (TYPICAL). BLACK OUTLINE ON CONCRETE PAVEMENT. SEE SHEET CO.0, DETAIL H-5.
- 11 PAVEMENT PAINTING: 24" WIDE WHITE STOP BAR.
- 12 SPOT ELEVATION AT FLOW LINE OF PROPOSED ENTRANCE. SEE CIVIL GRADING PLAN.
- 13 PROVIDE LANE DIVIDERS AND DIRECTIONAL ARROWS AT ALL DRIVES AND ENDS OF DRIVE AISLES.
- 14 ASPHALT PAVEMENT. SEE CIVIL SHEETS FOR LIMITS OF HEAVY DUTY.
- 15 12" MASONRY WALL ENCLOSURE FOR TRASH TOTE AND BALE STORAGE. SEE SHEET CO.0, DETAILS A-1.
- 16 CONCRETE LOADING BERTH AND RECEIVING PAD. SEE SHEET S11.
- 17 PARKING SETBACK IN COMPLIANCE W/ LOCAL ZONING REQUIREMENTS.
- 18 PAD MOUNTED TRANSFORMER W/ BOLLARDS ALL AROUND. SEE SHT. E0.1.
- 19 CEDAR SLAT GATES ON STL. POSTS. SEE SHT. CO.0, DTL. L-11.
- 20 FREE STANDING "ACCESSIBLE PARKING" SIGN (R7-B). SEE SHT. CO.1, DTL. A-18, A-4.
- 21 LANDSCAPED AREA.
- 22 WALGREENS PYLON SIGN. SEE SHEET A5.1.
- 23 6" CONCRETE DRIVE-THRU SLAB. SEE SHEET S11.
- 24 MIN. 24" OCTAGONAL REFLECTIVE STEEL STOP SIGN. SEE SHEET CO.0, DETAIL L-14 FOR SIZE REQUIREMENTS.
- 25 LIGHT POLE OR WALL MOUNTED LUMINAIRE. LIGHT POLE BASE SHALL BE 30" CLEAR OF CURB EXCEPT WHERE BEYOND PROPERTY LINE. SEE SHT. CO.0, DTL. H-B AND SHT. E0.1.
- 26 LINE OF CANOPY @ DRIVE THRU (UNDERSIDE @ 14'-0" A.F.F.).
- 27 CONCRETE PAD CORNERS TO BE CHAMFERED AT 45 DEGREE ANGLE (18"x18").
- 28 ADA ACCESSIBLE EXIT DOOR.
- 29 ACCESSIBLE PARKING DESIGN TO MEET ALL GOVERNING CODES. QUANTITY AS REQD. BY ADA ACCESSIBLE PARKING SPACES AND THEIR ACCESS AISLES SHALL BE 2% MAX. SLOPE IN ALL DIRECTIONS.
- 30 DRIVE APPROACHES WITHIN R.O.W. TO BE CONCRETE PVT.
- 31 BIKE RACK ON CONCRETE PAD. SEE SPECIFICATION SECTION 32 12 00-2.02F FOR ACCEPTABLE MANUF.
- 32 GAS METER WITH BOLLARDS.
- 33 LINE OF AWNINGS ABOVE (TYP.) SEE SHEET A2.2.
- 34 3'-0" WIDE DETECTABLE WARNING SURFACE. EXTEND TO ALL ACCESSIBLE PARKING STALLS. SEE SHT. CO.1 FOR DETAILS.
- 35 N/A
- 36 SIAMASE CONNECTION/FIRE DEPARTMENT.
- 37 ENTRY BOLLARDS W/ POLYETHYLENE COVERS 5'-4" CLEAR MAX.
- 38 "SERVICE ENTRANCE ONLY" SIGN.
- 39 "DO NOT BLOCK INTERSECTION" SIGN.

NLD HOLDINGS HUDSON, LLC.
 50 S. 6TH ST. SUITE 1480
 MINNEAPOLIS, MN 55402



Facilities Planning And Design 106 Wilmet Rd., Deerfield, IL 60015
 Tel (847) 940-2500

NO.	DATE	BY	DESCRIPTION
3	7/26/11	SD	ISSUE FOR CONSTRUCTION
2	8/22/11	SD	ISSUE FOR PERMIT & WAG CHECKSET
1	6/13/11	SD	ISSUE FOR CLIENT REVIEW

REVISIONS
 CERTIFICATION AND SEAL

BUILDING AND PARKING DATA

BUILDING AREA	14,490 S.F.
SITE AREA	87,315 S.F.
% SITE COVERAGE W/ BUILDING	16.6 %
HANDICAPPED PARKING (REQD. BY ADA)	3 SPACES
TOTAL PARKING (INCLUDES H.C.)	75 SPACES
ZONING	B2 GENERAL BUS.

MATERIAL LEGEND

- CONCRETE SURFACE.
- HEAVY DUTY ASPHALT PAVING. SEE SHT. CO.0 FOR DETAILS.
- LANDSCAPED AREAS- (PROVIDE AUTOMATIC SPRINKLER SYSTEM IN ANY LANDSCAPED AREAS INCLUDING PARKWAYS).

STORE NUMBER 15121

PROJECT NAME
WALGREENS
 141 CARMICHAEL ROAD
 HUDSON, WI

DRAWING TITLE
 SITE PLAN

CADD PLOT:	SCALE:	DRAWING NO.
VOID PLOT:	DRAWN BY:	A0.1
SUPERSEDES PLAN DATED:	DATE:	
	REVIEWED BY:	OF DWGS.

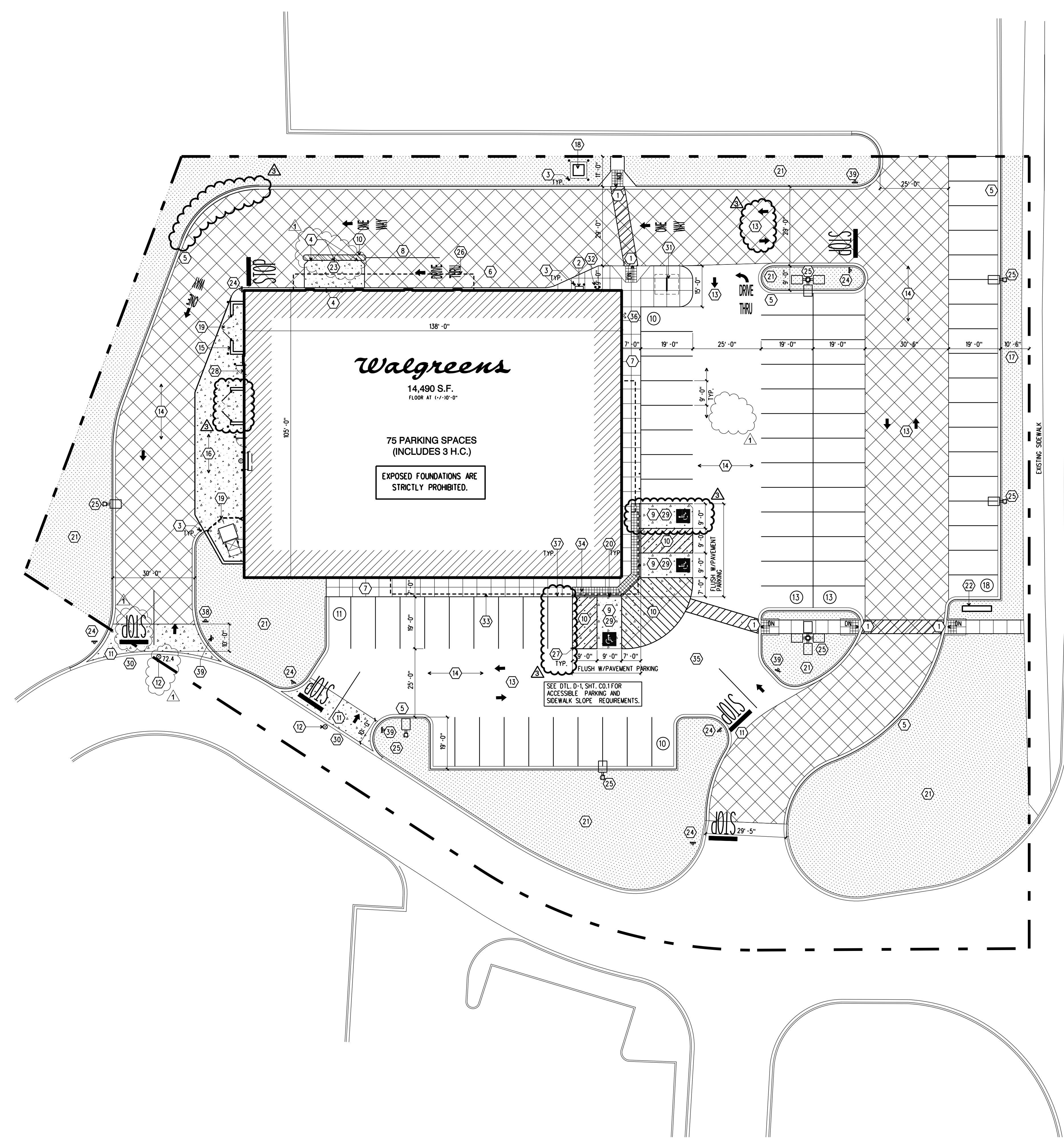

CHARMICHAEL ROAD



A-1
SITE PLAN
 SCALE: 1" = 20'-0"