



Walgreens

141 CARMICHAEL ROAD HUDSON, WI



PROJECT NO. 91126746

PROJECT TYPE

DRAWINGS/SPECIFICATIONS BY:

WALGREENS' CONSULTANT

LANDLORD'S CONSULTANT

ALL CONSTRUCTION WORK, UNLESS NOTED OTHERWISE, BY:

WALGREENS' CONTRACTOR

LANDLORD'S CONTRACTOR (TURNKEY CONSTRUCTION)

STORE	BUILDING
NEW <input checked="" type="checkbox"/>	NEW <input checked="" type="checkbox"/>
REMODELING <input type="checkbox"/>	EXISTING <input type="checkbox"/>
RELOCATION <input type="checkbox"/>	NEW SHELL ONLY <input type="checkbox"/>
OTHERS <input type="checkbox"/>	

2010 CRITERIA CONSTRUCTION BULLETINS

b10-001	SPECIFICATION MODIFICATIONS
b10-002	PHARMACY ARC SIGN REVISION & REMOVAL OF CHECK OUT ARC SIGN
b10-003	ETHERNET CABLE FOR THE EAS ANTENNAS
b10-004	ADA EXIT SIGN
b10-005	SPECIFICATION MODIFICATIONS
b10-006	MULTIPURPOSE ROOM AND PHARMACY SERVICE AREA UPDATES
b10-008	REMOVAL OF EXTERIOR 'PHOTO' SIGN
b10-009	OPEN CEILING LAYOUT
b10-011	E.F. BAVIS DRIVE-THRU SERVICE WINDOW DETAILS UPDATE
b10-013	ELECTRONIC ARTICLE SURVEILLANCE CHANGE
b10-014	SITE LIGHTING POLE BASE DIMENSION CORRECTION
b10-015	SPECIFICATION MODIFICATIONS
b10-016	EXTERIOR WALL MOUNTED LUMINAIRE COLOR AND MISC. CORRECTIONS
b10-019	REMOVAL OF GENERAL SALES WALL MOUNTED MIRRORS
b10-020	SIEMENS CONTROL DIAGRAM UPDATE
b10-021	'TO' LUMINAIRE SCHEDULE CLARIFICATIONS
b10-022	SPECIFICATION MODIFICATIONS
b10-023	PROTOTYPICAL PHOTO EQUIPMENT CHANGE & MISC. COORDINATION
b10-024	LOWER WINDOW SILLS, SPECIFICATION MODIFICATIONS, NEW BRANDING
b10-025	REPLACE MORTAR & PESTLE SIGNAGE WITH 'W' SIGNAGE
b10-026	PREMIER EUROACE CONTACT INFORMATION UPDATE
b10-027	SITE LIGHTING POLE AND HUBBELL CONTACT INFO UPDATES
b10-028	SPECIFICATION MODIFICATION
b10-029	INTERIOR ELEVATIONS: BRANDING AND DECO SUPPLEMENTAL
b10-030	ELECTRICAL UPDATES

DRAWINGS COMPLY WITH WALGREENS FISCAL 2010 CRITERIA

SITE DEVELOPMENT DATA

BUILDING AREA (FOOTPRINT)	14,490 S.F.
SITE AREA	87,315 S.F.
SITE COVERAGE W/ BUILDING	16.6 %
HANDICAPPED PARKING	3 SPACES
TOTAL PARKING (INCLUDES H.C.)	75 SPACES
ZONING	B2 GENERAL BUSINESS

NLD HOLDINGS HUDSON, LLC.
50 S. 6TH ST., SUITE 1480
MINNEAPOLIS, MN 55402



Facilities Planning And Design 106 Wilnot Rd., Deerfield, IL 60015
Tel (847) 940-2500

NO.	DATE	BY	DESCRIPTION
3	8/23/11	SD	WAG CHECKSET REVISIONS
3	7/28/11	SD	ISSUE FOR CONSTRUCTION
2	7/28/11	SD	OWNER COMMENT REVISIONS
2	7/7/11	SD	OWNER COMMENT REVISIONS
2	8/22/11	SD	ISSUE FOR PERMIT & WAG CHECKSET
1	6/13/11	SD	ISSUE FOR CLIENT REVIEW

REVISIONS

CERTIFICATION AND SEAL

STORE NUMBER 15121
PROJECT NAME
WALGREENS
141 CARMICHAEL ROAD
HUDSON, WI

DRAWING TITLE
COVER / TITLE SHEET

CADD PLOT:	SCALE:	DRAWING NO.
VOID PLOT:	DRAWN BY: SD	G001
SUPERSEDES PLAN DATED:	DATE: 4/8/11	
	REVIEWED BY:	OF DWGS.

WALGREEN CO. REPRESENTATIVE	OWNER	ARCHITECTURE, ELECTRICAL, PLUMBING, MECHANICAL	CITY OF HUDSON BUILDING DEPARTMENT
106 WILNOT RD. DEERFIELD, ILLINOIS 60015 TEL (847) 315-4751 FAX (847) 315-4900 CONTACT: DAN GARNEAU, AIA	NLD HOLDINGS HUDSON, LLC. 50 S. 6TH ST., SUITE 1480 MINNEAPOLIS, MN 55402 TEL (612) 313-2500 TEL (612) 313-2500 CONTACT: ALLISON KERN	CAMBURAS & THEODORE, LTD. 2454 E. DEMPSTER STREET, SUITE 202 DES PLAINES, ILLINOIS 60016 TEL (847) 298-1925 FAX (847) 298-0228 CONTACT: STEPHEN DUGUID	HUDSON BUILDING DEPARTMENT 505 THIRD STREET HUDSON, WI 54016 TEL (715) 386-4775 CONTACT: LIZ MOLINE

CITY OF HUDSON - BUILDING DEPARTMENT

ITEM	ISSUE	CHAPTER/ ARTICLE	ORDINANCE	ACTUAL	COMPLIANT	AGENCY/ TEST NO.	REMARKS
PART 1 - ZONING REQUIREMENTS - CITY OF HUDSON ZONING ORDINANCES - W/ ADOPTED AMENDMENTS							
1.01	Zoning District	Zoning Map	B2	B2	-	-	General Business
1.02	Min. Lot Area	CHAPTER 255-ATTACHMENT #2	20,000 S.F.	87,315 S.F.	-	-	2 Acres
1.03	Max. Floor Area Ratio	CHAPTER 255-ATTACHMENT #2	2.5	0.166	-	A0.1	-
1.04	Total Building Area	NA	NA	14,490 S.F.	-	A0.1	-
1.05	Building Height	CHAPTER 255-ATTACHMENT #2	60'-0"	28'-0" @ Entry Tower	-	A2.1	-
1.06	Minimum Side Yards	CHAPTER 255-ATTACHMENT #2	20'-0"	Compliant	-	A0.1	-
1.07	Minimum Front Yard	CHAPTER 255-ATTACHMENT #2	30'-0"	Compliant	-	-	-
1.08	Minimum Rear Yard	CHAPTER 255-ATTACHMENT #2	25'-0"	Compliant	-	-	-
1.07	Grade Elevation	CHAPTER 255-34	NA	NA	-	CIVIL	-
1.08	Off Street Loading	CHAPTER 255-50	1 Space	1 Space	-	A0.1	-
1.09	Off Street Parking	CHAPTER 255-49	1 Space per 200 S.F.	75	-	A0.1	-
1.10	Landscaping	CHAPTER 255-34	-	-	-	L1.1	-

PART 2 - BUILDING REQUIREMENTS - INTERNATIONAL BUILDING CODE 2006- WISCONSIN COMMERCIAL BUILDING CODE

2.01	Occupancy Classification	309.1, pg. 36	Mercantile Group M	Mercantile Group M	-	G001	-
2.02	Height & Area Limitations	Table 503, Pg. 74	4 Stories/12,500	1 Story/14,490 SF	-	A1.1	-
	a) exception to height	504.2	1 Story Incr. Allowed	1 Story	-	-	Automatic Sprinkler System Increase
	b) exception to area	506.3	300% Incr. Allowed	14,490 SF	-	-	Automatic Sprinkler System Increase 300% x 12,500 SF = 37,500 SF ALLOWED
2.03	Types of Construction	602.3, Pg. 81	TYPE II-B	TYPE II-B	-	G001	-
2.04	Mixed Occupancy Separations	TABLE 302.3.2	NA	NA	-	-	-
2.05	Reg. Hrs of fire resistance	Table 601, pg. 83	0 HRS	NOT REQ.	-	G001	-
	Exterior Bearing Walls	Table 601, pg. 83	0 HRS	NA	-	G001	-
	Exterior Non-Bearing Walls	Table 602, pg. 83	0 HRS	NA	-	-	-
	Interior Bearing Walls	Table 601, pg. 83	0 HRS	NA	-	-	-
	Interior Non-Bearing Walls	Table 601, pg. 83	0 HRS	0 HRS	-	-	-
	Columns	Table 601, pg. 83	0 HRS	0 HRS	-	-	-
	Columns supporting roof only	Table 601, pg. 83	0 HRS	0 HRS	-	-	-
	Beams	Table 601, pg. 83	0 HRS	0 HRS	-	-	-
	Beams supporting roof only	Table 601, pg. 83	0 HRS	0 HRS	-	-	-
	Floor Construction	Table 601, pg. 83	0 HRS	NA	-	-	-
	Roof Construction	Table 601, pg. 83	0 HRS	NA	-	-	-
2.10	Fire Resistive Requirements	Section 701, pg. 85	NA	NA	-	-	-
	a) Fire Walls Construction	705.1, pg. 90	NA	NA	-	-	-
	b) Parapets	704.11.1, pg. 89	NA	NA	-	-	-
	c) Stairway Enclosures	1019.1, pg. 214	NA	NA	-	-	-
	d) Elevator Enclosures	707.1, pg. 93	NA	NA	-	-	-
	f) Enclosure of wells & chutes	707.1, pg. 93	NA	NA	-	-	-
	g) Other Enclosures	7 (15-8-240)	NA	NA	-	-	-
	h) Interior Wall & Cing finishes	803.1, pg. 157	Class A	Compliant	-	A1.2	-
2.13	Fire Protection Equipment	Section 901, pg. 163	Must Comply w/ 903.1	-	-	-	Automatic Sprinkler System
	a) Sprinkler Systems	903.1, pg. 166	Must Comply w/ 903.1	-	-	-	Automatic Sprinkler System

PART 3 - EXIT REQUIREMENTS

3.01	Types of Exits	Section 1008.1, pg. 199	Must Comply	Compliant	-	-	-
3.02	Max FA per occupant	Table 1004.1.2, pg. 195	30SF/Occupant	433 People total	-	A1.1	Storage: 300 SF/Occupant- 6 People
3.03	Minimum No. Of Exits	Table 1018.1, pg. 214	2	2	-	A1.1	-
3.04	Travel distance to exits	Table 1015.1, pg. 212	250'-0" Max.	194'- Complies	-	A1.1	Automatic Sprinkler System
	a) Increase permitted	Table 1015.1, pg. 212	NA	NA	-	A1.1	Automatic Sprinkler System
	b) Dead end corridor	1016.3, pg. 215	20'-0" Max.	NA	-	A1.1	-
3.05	Capacity of Exits	Table 1005.1, pg. 196	.15"/Occupant	112" Total- Compliant	-	A1.1	.15" X 433 People= 65" reqd.
	Minimum width of door opening	1008.1.1, pg. 199	32"	34" Complies	-	A1.1	-
	Swing of Exit Doors	1008.1.2, pg. 199	Direction Of Travel	Compliant	-	A1.1	-
	Hardware	1008.1.8.1, pg. 202	NA	Compliant	-	A4.3	-
	Revolving Doors	1008.1.3.1, pg. 200	NA	Compliant	-	-	-
	Landings	1008.1.5, pg. 210	44" Direct. of Travel	Compliant	-	A0.1	-
	Handrails	1009.10, pg. 214	Compliant	Compliant	-	-	-
	Construction	1020.3, pg. 216	1 hr. MIN.	Compliant	-	-	-
	Enclosures	1020.1, pg. 223	1 hr.	Compliant	-	-	-
	Headroom	1003.2, pg. 194	7'-0"	Complies	-	A1.1	-

A-1	CODE MATRIX
NO SCALE	

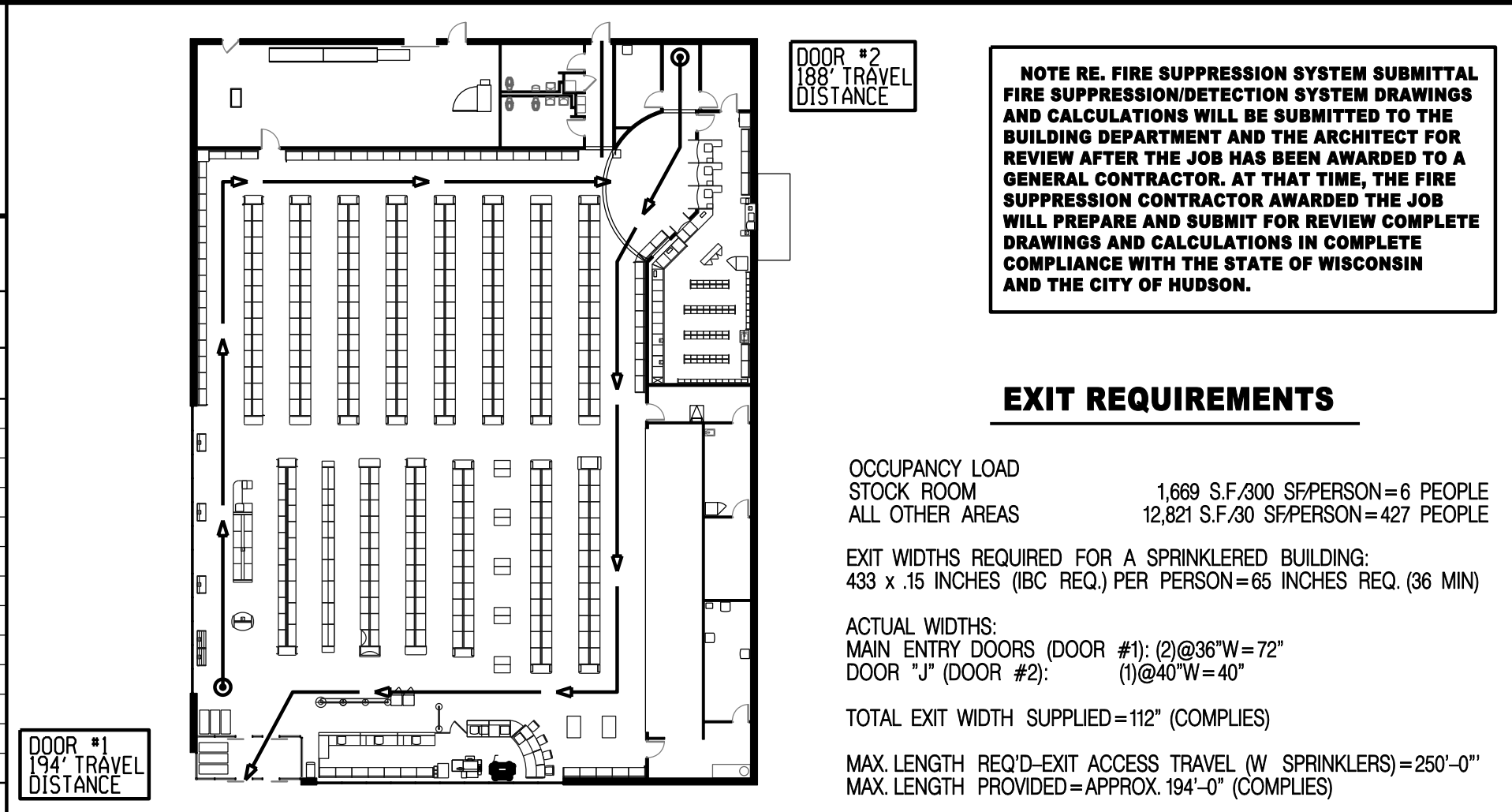

APPLICABLE CODES	BUILDING DATA
PROPOSED ZONING: B-2 GENERAL BUSINESS	CONSTRUCTION TYPE: TYPE II-B UNPROTECTED, NEW CONSTRUCTION, FULLY SPRINKLERED
APPLICABLE CODES:	OCCUPANCY CLASS: M - MERCANTILE
WISCONSIN COMMERCIAL BUILDING CODE- (COMM 61-66)	OCCUPANT LOAD: 433 PEOPLE
NATIONAL ELECTRIC CODE- (COMM 16)	FIRE PROTECTION SYSTEM: SPRINKLER SYSTEM AND CODED SIGNAL SENDING SYSTEM
WISCONSIN STATE PLUMBING CODE- (COMM 81-87)	MAXIMUM PARAPET HEIGHT (@ ENTRY): 28'-0"
WISCONSIN STATE MECHANICAL CODE- (COMM 45, 64)	GROUND FLOOR (1 STORY) TOTAL: 14,490 S.F.
NFC MOST CURRENT EDITION	



A-8	AREA MAP
NO SCALE	

SHEET #	TITLE
G001	COVER/TITLE SHEET
A0.1	SITE PLAN
CIVIL ENGINEERING	
C0.0	CIVIL ENGINEERING DATA
C0.1	ADA DETAILS
C1.1	COVER
C1.2	SURVEY
C1.3	DEMOLITION PLAN
C1.4	SITE PLAN
C1.5	GRADING AND DRAINAGE PLAN
C1.6	EROSION CONTROL PLAN
C1.7	UTILITY PLAN
C1.8	ACCESSIBLE GRADING PLAN
C1.9	CITY DETAIL SHEET
C1.0	DETAIL SHEET
L1	LANDSCAPE PLAN
L2	IRRIGATION PLAN
ARCHITECTURAL	
D-111	FIXTURE PLAN
A1.1	GENERAL FLOOR PLAN AND SCHEDULES AND BASE PLANS
A1.2	REFLECTED CEILING PLAN AND SPECIFICATIONS
A1.3	ROOF PLAN AND DETAILS
A2.1	EXTERIOR ELEVATIONS, DETAILS AND SIGN DATA
A2.2	BUILDING SECTIONS
A2.3	SECTIONS AT DRIVE-THROUGH
A2.4	SECTIONS AND DETAILS
A3.1	INTERIOR ELEVATIONS, DATA & DETAILS
A4.1	STANDARD DETAILS & SPECIFICATIONS
A4.2	STANDARD DETAILS & SPECIFICATIONS
A4.3	STANDARD DETAILS & SPECIFICATIONS
A4.4	DRIVE-THRU DETAILS
A5.1	LED READERBOARD PYLON SIGN AND DETAILS
A5.2	EXTERIOR SIGN DETAILS
A6.1	FLOORING PLAN
STRUCTURAL	
S0.1	SATELLITE DISH ANTENNA SUPPORTS
S1.0	STRUCTURAL NOTES AND DETAILS
S1.1	FOUNDATION PLAN, COLUMN AND FOOTING SCHEDULE
S1.2	STRUCTURAL DETAILS
S1.3	LOWER FRAMING PLAN & DETAILS
S1.3A	MASONRY REINFORCING ELEVATIONS
S1.4	ROOF FRAMING PLAN & DETAILS
S1.5	UPPER CANOPY FRAMING PLAN
FIRE SUPPRESSION	
FP1.1	FIRE SUPPRESSION PLAN (FOR REFERENCE ONLY)
MECHANICAL	
M1.1	FLOOR PLAN - MECHANICAL
M2.1	MECHANICAL SCHEDULE & DETAILS
M2.2	MECHANICAL SCHEDULES
M3.1	WIRING BLOCK DIAGRAM
PLUMBING	
P1.1	FLOOR PLAN - PLUMBING
P2.1	PLUMBING DETAILS AND SCHEDULES
P2.2	PLUMBING RISER DIAGRAMS
ELECTRICAL	
E0.1	SITE ELECTRICAL PLAN
E0.1A	SITE PHOTOMETRIC PLAN
E1.1	MAIN FLOOR PLAN - LIGHTING
E1.2	MAIN FLOOR PLAN - POWER
E1.3	MAIN FLOOR PLAN - ETHERNET & SATELLITE SYSTEM
E1.4	MAIN FLOOR PLAN - BURGLAR ALARM & CCTV SYSTEM
E1.5	MAIN FLOOR PLAN - TELEPHONE & SOUND SYSTEM
E1.6	MAIN FLOOR PLAN - FIRE ALARM SYSTEM AND SPARE CONDUIT
E1.7	MAIN FLOOR PLAN - CHANNEL LETTER LED SYSTEM
E2.1	FEDDER DIAGRAM (120/208V) ELECTRICAL DETAILS
E2.1A	CONTROL SCHEDULES
E2.1B	CONTROL DIAGRAMS
E3.1	ELECTRICAL PANEL SCHEDULES (120V)
E4.1	LUMINAIRE SCHEDULE AND DETAILS
E4.2	SATELLITE SYSTEM DETAILS
E4.3	ELECTRICAL DETAILS
E4.4	ELECTRICAL DETAILS
E4.5	WALK-IN COOLER AND FREEZER WIRING DIAGRAMS
E4.6	AIR CURTAIN WIRING DIAGRAMS
A-13	SHEET TITLES